

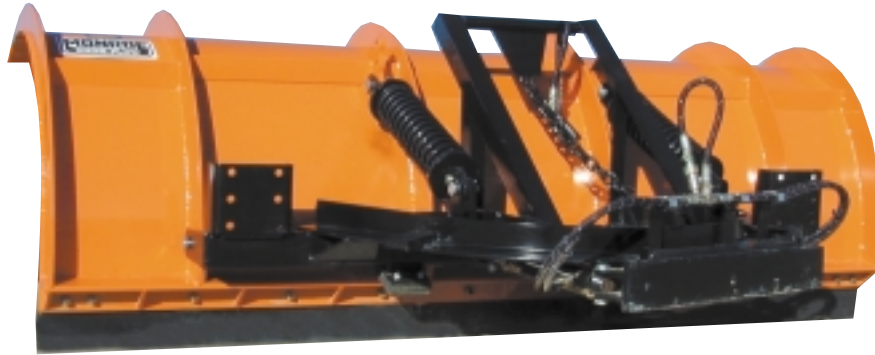

# MONROE REVERSIBLE SNOWPLOW FULL TRIP MOLDBOARD



## Standard Specifications:

- \* 10 Gauge Roll Formed Moldboard
- \* Six 1pc 1/2" Flame Cut Ribs
- \* Dual Compression Trip Spring Assemblies
- \* Two 3" x 10" Double Acting Power Reverse Cylinders with Cushion Valve
- \* Built-In Monroe Level Lift Assembly
- \* Stress Proof Machined Pins
- \* All Hardware Zinc Plated
- \* Moldboard and Pushframe 100% Continuously Welded
- \* Moldboard Painted Powder Coat Orange
- \* Pushframe Painted Powder Coat Black
- \* 14" Push Height
- \* Available in 10', 11' & 12'



**STANDARD**

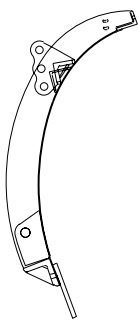

**INTEGRAL**

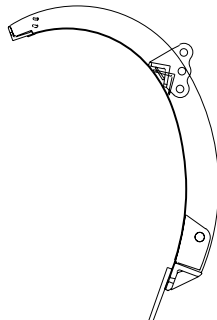

Standard Moldboard vs 12" Extension on Integral Shield Moldboard



**CAUTION:** Plow weight, mounting distance from axle, hitch type and weight, and other additional equipment mounted on the front of a truck will require heavier truck GAWR (Gross Axle Weight Ratings). Contact chassis manufacturer for exact GAWR requirements for your specific equipment.

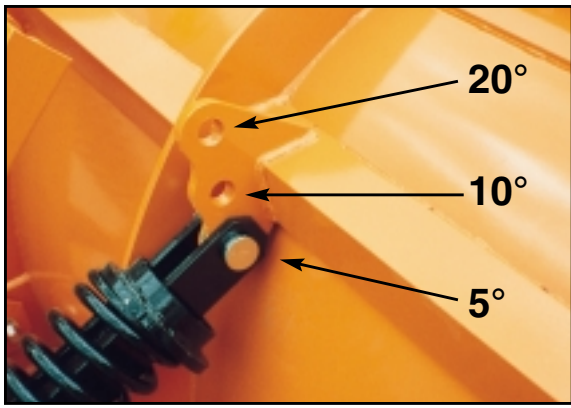

Simple Three Position Adjustment for Plow Cutting Edge Attack Angle

### Options:

- \* Rubber Snow Deflector
- \* Wrap Around Curb Guards
- \* Flexible Plastic or Cable Markers
- \* Adjustable Parking Jack
- \* Moldboard Shoes
- \* 3/4" x 6" Carbide Cutting Edge
- \* 4" Reversing Cylinders
- \* Mechanical or Canister Trip
- \* Polymer Moldboard
- \* Skid Shoes, Steel Casters & Pneumatic Tires

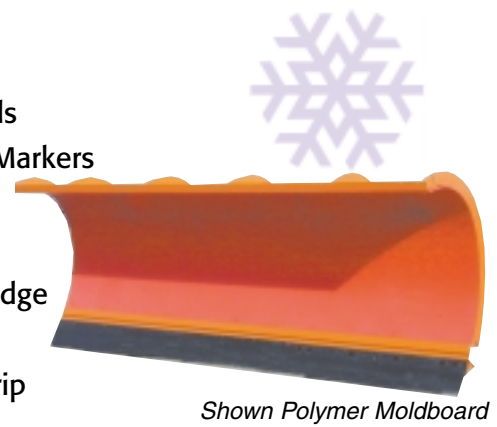

Shown Polymer Moldboard

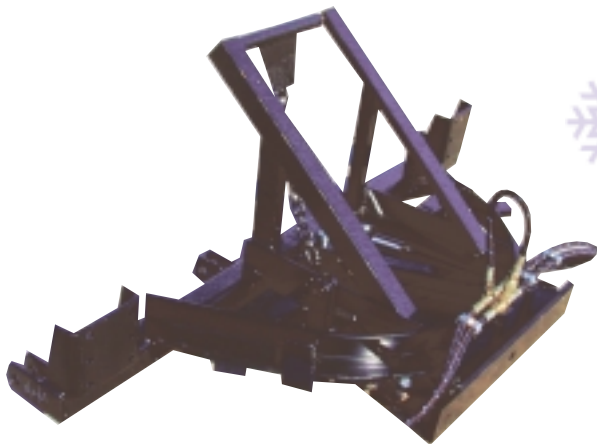

The Patented Level Lift allows plow to be parallel to the road surface at all times - raised, lowered, or angled.

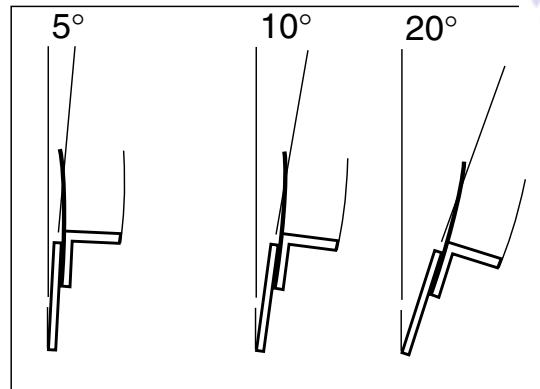

Force Required to Trip Moldboard

LIGHT TRIP

MEDIUM TRIP

HARD TRIP

## THE MONROE SNOWPLOW SPECIFICATIONS

PLOW MODEL NO.	OVERALL LENGTH	HEIGHT W/8" CUTTING EDGE	NO. OF 1/2" VERTICAL RIBS	SEMI CIRCLE	MOLDBOARD BOTTOM ANGLE	MOLDBOARD TOP ANGLE	CUTTING EDGE SIZE	APPROX. WEIGHT (LBS)	MOLDBOARD THICKNESS	CUTTING WIDTH AT 35 DEGREES
MP36R10-CT	10'	36"	6	3 1/2" X 3 1/2" X 1/2"	4" X 4" X 3/4"	2" X 3" X 3/8"	5/8" X 8"	1475	10 GA	8'2"
MP36R10-ISCT	10'	36"	6	3 1/2" X 3 1/2" X 1/2"	4" X 4" X 3/4"	2" X 3" X 3/8"	5/8" X 8"	1500	10 GA	8'2"
MP36R11-CT	11'	36"	6	3 1/2" X 3 1/2" X 1/2"	4" X 4" X 3/4"	2" X 3" X 3/8"	5/8" X 8"	1500	10 GA	9'0"
MP36R11-ISCT	11'	36"	6	3 1/2" X 3 1/2" X 1/2"	4" X 4" X 3/4"	2" X 3" X 3/8"	5/8" X 8"	1525	10 GA	9'0"
MP41R10-CT	10'	41"	6	3 1/2" X 3 1/2" X 1/2"	4" X 4" X 3/4"	2" X 3" X 3/8"	5/8" X 8"	1575	10 GA	8'2"
MP41R10-ISCT	10'	41"	6	3 1/2" X 3 1/2" X 1/2"	4" X 4" X 3/4"	2" X 3" X 3/8"	5/8" X 8"	1575	10 GA	8'2"
MP41R11-CT	11'	41"	6	3 1/2" X 3 1/2" X 1/2"	4" X 4" X 3/4"	2" X 3" X 3/8"	5/8" X 8"	1625	10 GA	9'0"
MP41R11-ISCT	11'	41"	6	3 1/2" X 3 1/2" X 1/2"	4" X 4" X 3/4"	2" X 3" X 3/8"	5/8" X 8"	1650	10 GA	9'0"
MP41R12-CT	12'	41"	6	3 1/2" X 3 1/2" X 1/2"	4" X 4" X 3/4"	2" X 3" X 3/8"	5/8" X 8"	1695	10 GA	9'10"
MP41R12-ISCT	12'	41"	6	3 1/2" X 3 1/2" X 1/2"	4" X 4" X 3/4"	2" X 3" X 3/8"	5/8" X 8"	1725	10 GA	9'10"
MP48R11-CT	11'	48"	6	3 1/2" X 3 1/2" X 1/2"	4" X 4" X 3/4"	2" X 3" X 3/8"	5/8" X 8"	1755	10 GA	9'0"
MP48R11-ISCT	11'	48"	6	3 1/2" X 3 1/2" X 1/2"	4" X 4" X 3/4"	2" X 3" X 3/8"	5/8" X 8"	1800	10 GA	9'0"
MP48R12-CT	12'	48"	6	3 1/2" X 3 1/2" X 1/2"	4" X 4" X 3/4"	2" X 3" X 3/8"	5/8" X 8"	1845	10 GA	9'10"
MP48R12-ISCT	12'	48"	6	3 1/2" X 3 1/2" X 1/2"	4" X 4" X 3/4"	2" X 3" X 3/8"	5/8" X 8"	2000	10 GA	9'10"



Manufactured by:  
**Monroe Snow & Ice Control**  
 1051 W. 7th Street • Monroe, WI 53566  
 800-880-0109 • 608-329-8105  
 608-328-8390 Fax  
 Web Site: [www.monroetruck.com](http://www.monroetruck.com)  
 E-mail: [snowandicecontrol@monroetruck.com](mailto:snowandicecontrol@monroetruck.com)

Distributed by: